

Slip On Flanges for Pipe (All Schedules) – Class 150 Spacing – Light Weight

Dimensions in inches, Weight in LBS

Part #	PIPE SIZE	ID Type	O.D.	I.D.	B.H.C. DIA	B.H. DIA	NO. B.H.	THK	WEIGHT
KLW2P	2	Pipe	6	2.36	4.75	0.75	4	0.5	3.0
KLW2.5P	2-1/2	Pipe	6	2.88	4.75	0.75	4	0.5	4.0
KLW3P	3	Pipe	7	3.57	5.5	0.75	4	0.5	4.7
KLW3.5P	3-1/2	Pipe	7	4.06	5.5	0.75	8	0.5	5.5
KLW4P	4	Pipe	9	4.57	7.5	0.75	8	0.5	6.2
KLW5P	5	Pipe	10	5.66	8.5	0.88	8	0.5	7.2
KLW6P	6	Pipe	11	6.72	9.5	0.88	8	0.5	8.4
KLW8P	8	Pipe	13.5	8.72	11.75	0.88	8	0.5	11.4
KLW10P	10	Pipe	16	10.88	14.25	1	12	0.5	14.6
KLW12P	12	Pipe	19	12.88	17	1	12	0.5	21.6
KLW14	14	NA	21	14.19	18.75	1.13	12	0.5	26.5
KLW16	16	NA	23.5	16.19	21.25	1.13	16	0.5	31
KLW18	18	NA	25	18.19	22.75	1.25	16	0.5	32

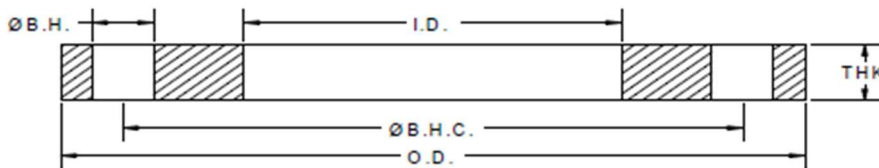

- Flanges designed to slip over outside of NPS pipe (all schedules) and to be welded in place
- Flange material is carbon steel to AWWA C207-13 specifications

***** FLANGES ARE ONLY CLASS 150 SPACING, NOT THICKNESS (1/2 INCH THICK)*****